

OCTOPUS SYSTEM

OWNER'S MANUAL



OCEANREEF
underwater, naturally.

More than 70 years, OCEAN REEF has been involved in the underwater diving industry. We have contributed much to this industry, from fins and snorkels to the most modern systems of underwater communication. Through the spirit of intrepid pioneers, brilliant inventors, passionate divers, and dynamic entrepreneurs, OCEAN REEF has been able to turn dreams into reality in the underwater world.



OCEAN REEF USA



MESTEL SAFETY ITALY

In order to limit our paper consumption, and as a part of our environmental friendly and responsible approach, OCEAN REEF prefers to put user documentation online rather than print them out.

Please refer to our web site:
diving.oceanreefgroup.com/support/

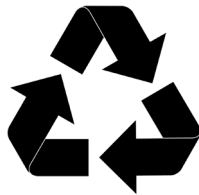

© OCEAN REEF 2020

#UNDERWATERNATURALLY

IMPORTANT

Any critical information or warnings that might affect the performance or result in the injury or death of the technician, regulator owner, or other persons is highlighted with the following symbols:



Indicates an imminently hazardous situation which, if not avoided, will result in death or serious injury.



Indicates a potentially hazardous situation which, if not avoided, could result in death or serious injury.



Indicates a potentially hazardous situation which, if not avoided, may result in minor or moderate injury. It may also be used to alert against unsafe practices.

OCEANREEF reserves the right to modify any products, processes and manufacturing techniques at any time. It is the technicians' responsibility to acquire the latest information and parts from OCEANREEF for service and repairs to be performed.

IMPORTANT

If the instructions provided in the manual are unclear or difficult to understand, please contact OCEANREEF at infoitaly@oceanreefgroup.com before using the regulator or attempting any repairs.



Carefully follow these and all the other instructions concerning your OCEANREEF products and all other SCUBA equipment. Failure to do so could lead to serious injury or death.



As with all SCUBA equipment, OCEANREEF Octopus is designed to be used by trained, certified divers only. Failure to fully understand the risks of using such equipment may result in serious injury or death. DO NOT use this Octopus or any SCUBA equipment unless you are a trained, certified SCUBA diver.

LIMITS

- The OCEANREEF Octopus described in this manual can be used only connected to an OCEANREEF first stages.
- Maximum depth: 50 m / 162 feet.



The manufacturer declines responsibility for damage to persons or property resulting from the use of different first stages / second stages / Octopus not from OCEANREEF. The OCEANREEF Octopus second stages have been designed and tested for use on first stage low pressure ports. An Octopus second stage MUST NOT be substituted for a primary second stage.

 **WARNING**

FOR NON-EUROPEAN COUNTRIES ONLY

OCEANREEF Octopus system is compatible with and **EXCLUSIVELY** designed for use with open-circuit SCUBA equipment that uses compressed air or oxygen-rich mixtures (Nitrox) with oxygen content not greater than 40%. Failure to observe this warning may result in serious or fatal injury to the user caused by fires, explosions, or deterioration or breakage of the equipment.

DURING THE DIVE

- Keep the Octopus connected to your BCD in a way that if you need to release only the quick connection hose, the regulator, is not falling off.
- Use a dust cap to prevent foreign matter from entering the second stage through the mouthpiece *dust cap not included.
- When the regulator is out of the diver's mouth, free flowing of air may occur. This problem can be easily avoided either by using the dive/pre-dive switch or by turning the regulator with the mouthpiece facing downwards and let water fill it completely. This must be tested BEFORE DESCENT. If Free Flow should continue, abort the dive and do not descend.

POST-DIVE CARE AND PERIODIC MAINTENANCE

Your Octopus should be rinsed with fresh water while pressurized. This allows the second stage to be rinsed internally without introducing contaminants into critical sealing areas.

Also run water into the mouthpiece and out of the exhaust valve to remove foreign matter. If the regulator is not pressurized, do not depress the purge button while rinsing. Actuation of the purge function may allow particles to contaminate the valve seat and cause leakage. Allow the Octopus to dry thoroughly before putting it away.

If the regulator is exposed for prolonged periods to direct sunlight, or left in greasy or dusty environments, some of its components may be damaged.

No lubricants are required; in fact, they should not be used during the routine maintenance procedures normally performed by the user.

 **WARNING**

The correct functioning of the Octopus is dependent upon proper maintenance. Therefore, your regulator should be submitted to an OCEANREEF authorized service center for inspection at least once a year.

Failing to do so, shall void warranty. OCEAN REEF will not be held liable for any product that has not been properly and periodically serviced through and authorized service center.

Your OCEANREEF Octopus has been constructed using manufacturing processes and materials which are the result of many years of continuing research and evolution. This sophisticated technology is backed by the guarantee that the product has been tested at our facility in Genova, Italy. All this is synonymous with reliability, a fundamental requirement for any piece of diving equipment, which you will find in EVERY OCEANREEF product.

 **WARNING**

Carefully read this instruction manual before use, and keep it for future reference.

INTRODUCTION

Congratulations for purchasing the OCEANREEF Octopus system.

Description of OCEANREEF Octopus System

Standard downstream valve with dive-prediver switch, no adjustment knob.

Weight (without hose) **230g**

Quick connection male part assembled on the Octopus.

Quick connection Hose length 120cm

Yellow Extraflex hose.

Static intermediate pressure 9.5-9.8bar

NO FIRST STAGE INCLUDED

OCTOPUS ASSEMBLY

Use a 4mm Allen wrench to remove the LP port plug on the first stage adjacent to the hose of the primary second stage, then screw the loose end of the Octopus hose into the open port and tighten by hand using a 14mm wrench without using excessive force.

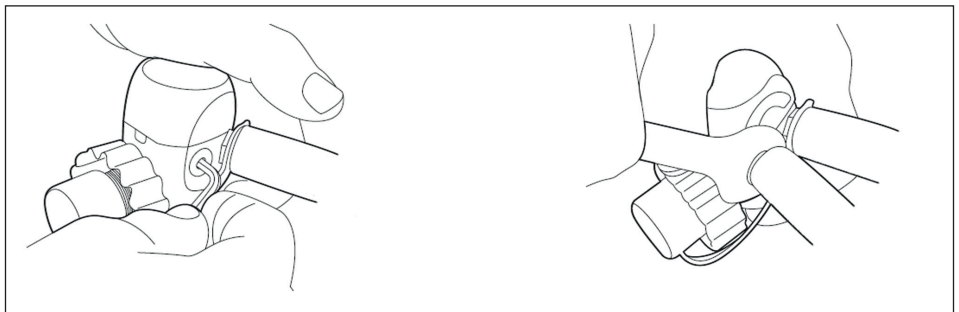

WARRANTY

1. OCEAN REEF Octopus system is guaranteed to be free of material or manufacturing defects for a period of 24 months from the time the unit is purchased.
2. For the duration of the guarantee, the Company's responsibility is limited to replacement of any parts that are defective and that have not been used incorrectly or handled negligently. The Octopus system must be returned to the outlet from which it was bought.
3. Even during the guarantee period, this guarantee shall not be valid where:
 - Damage was caused by incorrect handling or carelessness.
 - Damage was caused by the first stage falling after it was purchased.
 - Damage caused by fire, earthquake, floods, lightning, or other natural disasters.
 - The product has not been serviced as required through an OCEAN REEF authorized service center.
 - The product has been tampered with or has been repaired/ serviced with non-original parts.



Ocean Reef Group



MESTEL Safety s.r.l
Via Arvigo 2, 16010 Genova (Italia)
Phone +39 010 7082011
E-mail: infoitaly@oceanreefgroup.com

OCEAN REEF Inc
2510 Island View Way
Vista, CA 92081
Phone +1 760 744 9430
Fax +1 760 744 9525
E-mail: operator@oceanreefgroup.com



diving.oceanreefgroup.com
oceanreefgroup.com

